



Community Learning Program

Program Summary – Location Recommendation

- Background / Board Goals
- Educational Program
- Community Support Services
- Facility Option Review (Patrick May – Architect)
- Timelines/phases
- Summary criteria
- Recommendation for location
- Next steps



Encourage the growth of collaborative, adaptive and personalized learning environments*

-  Strengthen engagement and connection for all learners.
-  Provide increased and unique opportunities for personalized learning.
-  Enhance collaboration among all students, parents, partners, and educators to create relevant learning opportunities.





BC's Education Plan key elements

- *Quality teaching and learning*
- *Personalized learning for every student*
- *Learning empowered by technology*

* 2011-2021 10-Year Strategic Plan



Develop and promote innovative and sustainable programs*

-  Increase access to existing and future specialty programs.
-  Expand online course offerings provided through Distributed Learning.
-  Promote greater awareness of the specialty program opportunities and quality of instruction available to students.
-  Develop and implement a consolidated alternate program to meet a diverse range of student needs.



BC's Education Plan key elements

- *Flexibility and choice*
- *Learning empowered by technology*

* 2011-2021 10-Year Strategic Plan



Strengthen and expand reciprocal community relations*

-  Strengthen the delivery of services to support children and families through closer connections with the community.
-  Provide seamless transitions for all students at each stage of their growth and development.
-  Enhance opportunities for all students by expanding and integrating school and community services.

* 2011-2021 10-Year Strategic Plan





Develop and implement a consolidated alternate program to meet a diverse range of student needs*

- Implement the pilot CHOICES Program at Sutherland Secondary and proceed with the expansion of the CHOICES Program to each secondary school, building upon the pilot program and making any necessary adjustments,
- Collaborate with community agencies to develop a partnership model that enhances the services available to students and the effective delivery of community services at both the school and district level,
- Establish and support the consolidated alternate program at a district level in collaboration with community agencies,
- Continue to monitor and support the expansion of the CHOICES Program to each secondary school and the effective implementation of the consolidated alternate program.

* 2011-2014 Three-Year Operating Plan



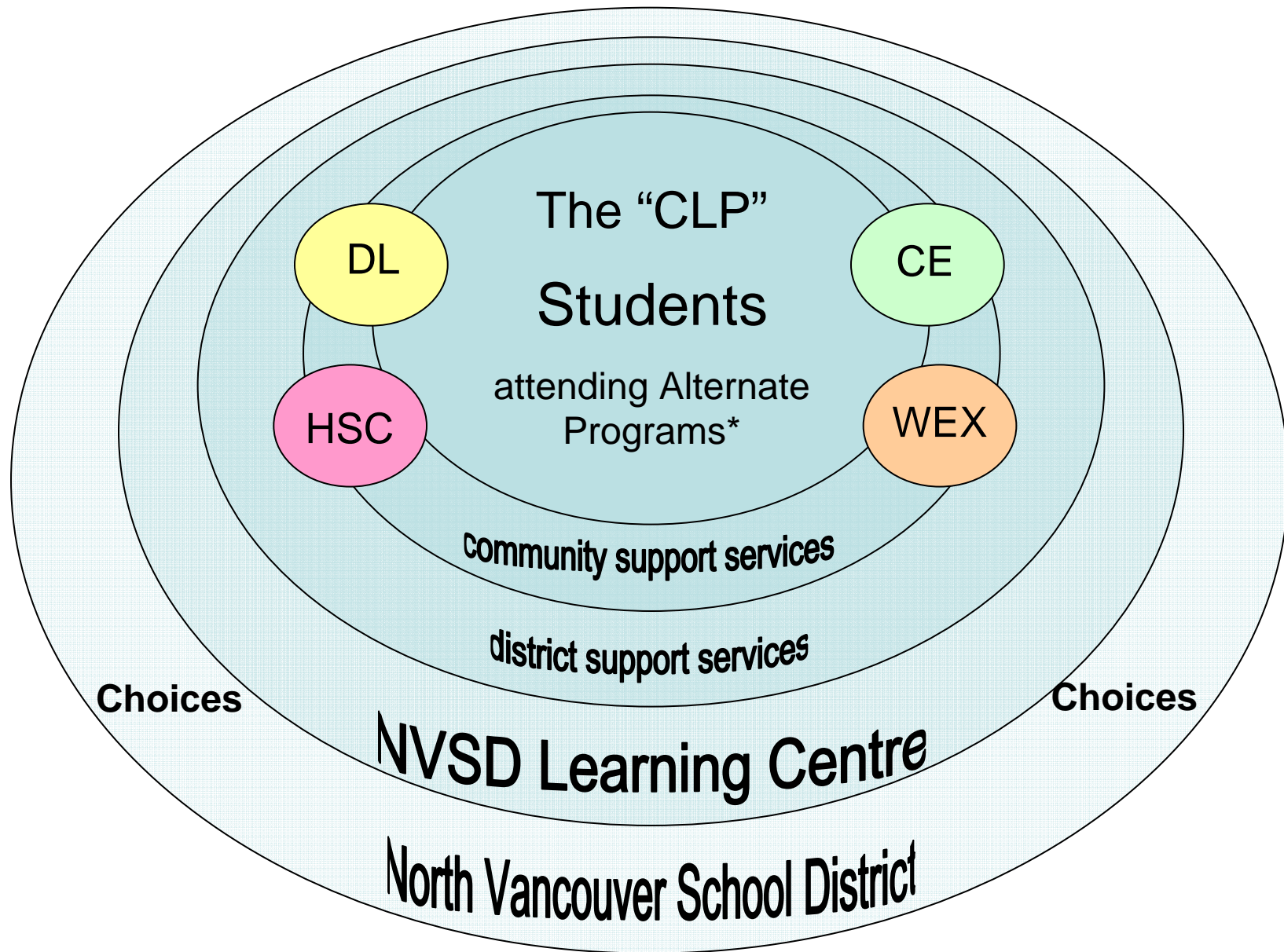

* Alternate Programs (meeting Ministry of Education criteria)



Educational Program - Background

March through June 2011 and September through November 2011

Meetings: Working Group of 8 educators meets every 2 weeks
80-100 Working Group hours per month
40-60 additional hours per month (Steering Group)

Focus: Designing, developing and initiating the Community Learning Program (working title of *PEAK Secondary Program*)

Site visits and locations:

North Vancouver, Burnaby, Abbotsford, Coquitlam, Vancouver, Sooke/Langford, Victoria, Duncan/Cowichan, Nanaimo

All Working Group members have attended various locations

All Secondary Administrators are presently visiting locations to review similar in-school CHOICES programs and to review other districts' alternative schools



Encourage the growth of collaborative, adaptive and personalized learning environments*

- Flexible schedules for students
 - time of day, number of classes, full-time, part-time
- Differentiated instructional methodologies
- Integrated instructional approaches
 - learning outcomes integrated across the curriculum
 - i.e. applications of math through carpentry
- Increased course options to meet students' interests
 - electives, able to take courses from different grade levels
- Reduced class size student to teacher ratio 15-20: 1
 - One teacher and one Youth Engagement Worker

* 2011-2021 10-Year Strategic Plan



Develop and promote innovative and sustainable programs*

- Flexible programming integrating blended Distributed Learning program with face-to-face instruction
- Opportunity for students to cross-enroll at other schools for district specialty programs
- Opportunity to participate fully in career programs, work experience, apprenticeships, ITA initiatives, etc.
- Smooth transitions from Choices and to Choices
- Course selection is aligned with graduation requirements, enabling the students to select from a wide array of elective courses offered within the program, the Learning Centre, or in the community

* 2011-2021 10-Year Strategic Plan



Strengthen and expand reciprocal community relations*

Wrap-around support services for students

- Health & nutrition (food program breakfast/lunch)
- Youth services for counseling, medical, physical and mental health services

Community services wishing to partner

- Vancouver Coastal Health
- Ministry of Child and Family Development
- North Shore Neighbourhood House
- Capilano Youth Services, Parkgate Youth Services
- North Shore Multicultural Society
- Tsleil-Waututh and Squamish Nations

* 2011-2021 10-Year Strategic Plan



PROPOSED CONSOLIDATED FACILITY
Programs

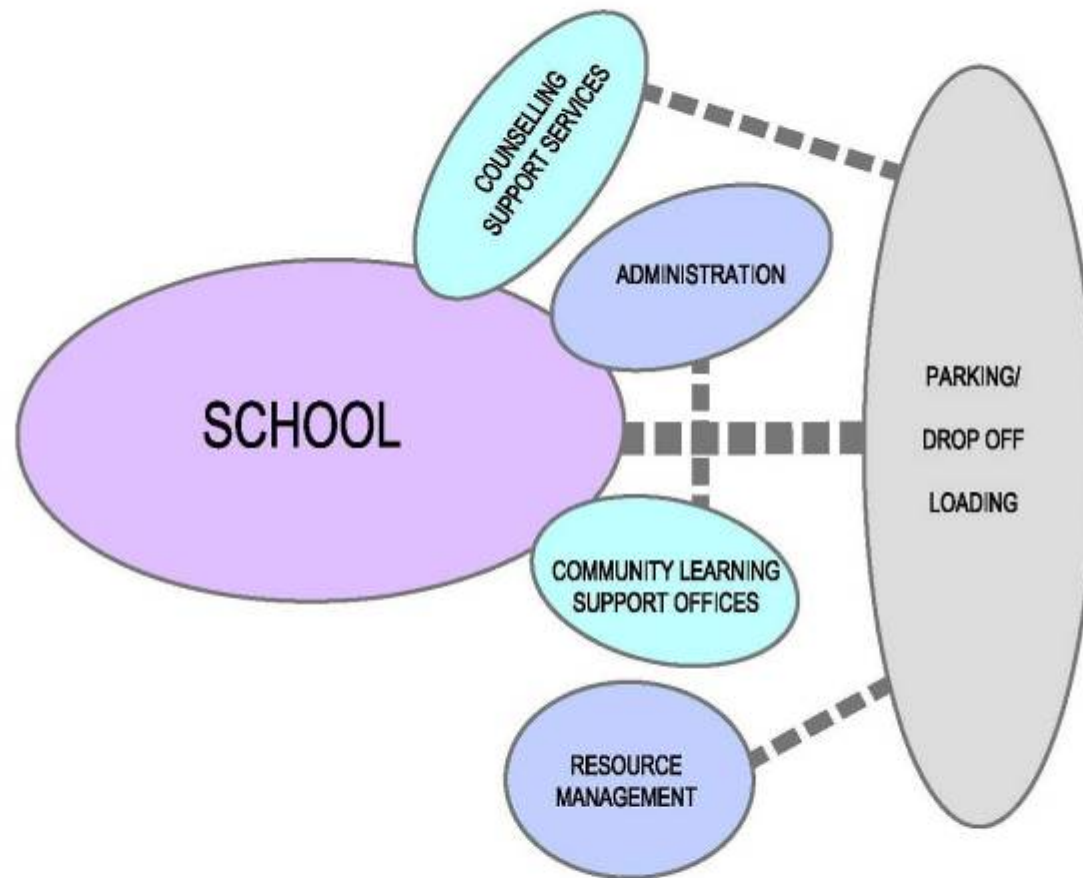

PROPOSED CONSOLIDATED FACILITY

Program Relationship Diagram

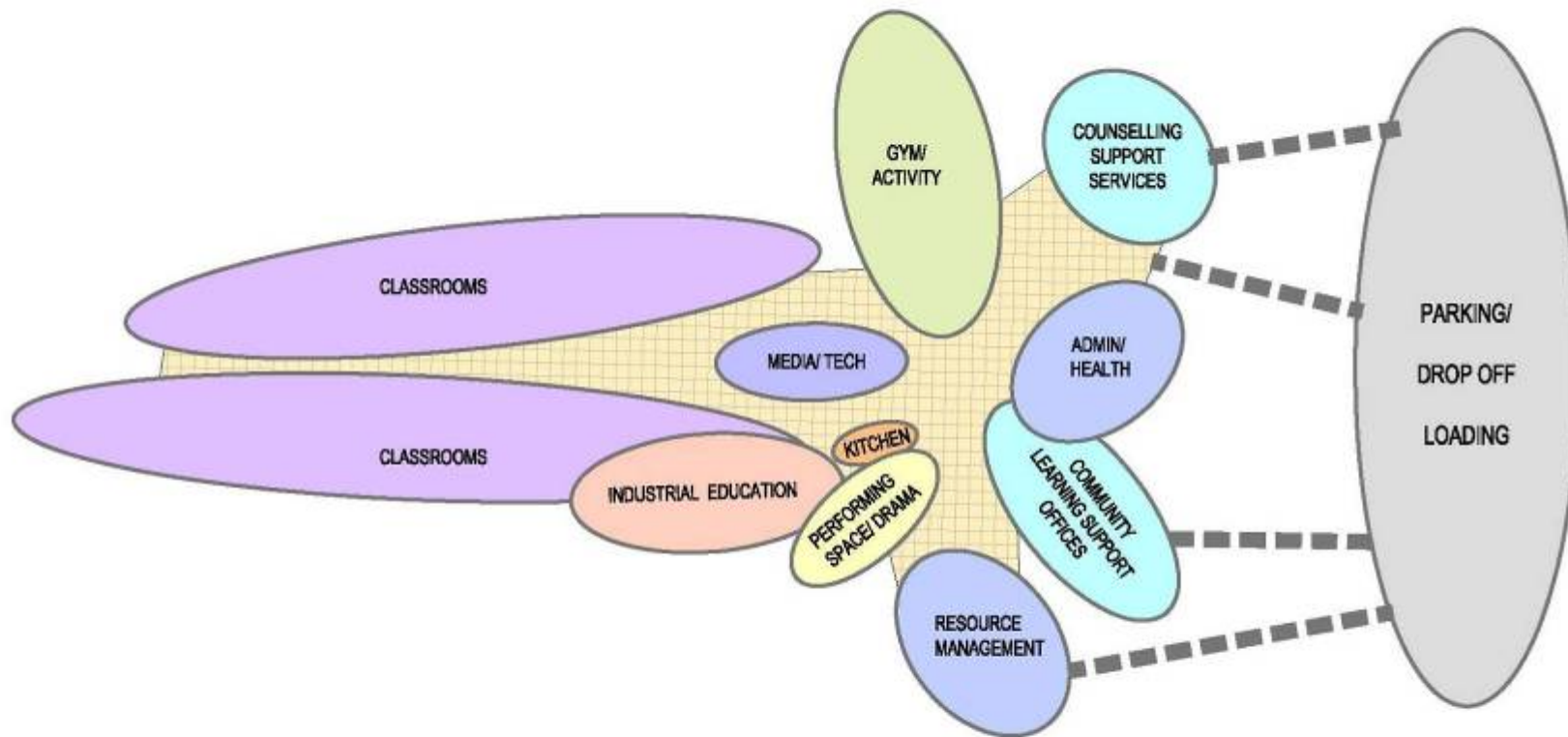

PROPOSED CONSOLIDATED FACILITY
 Detailed Relationship Diagram
 Based on 200-250 students + 40 - 50 Staff + outside support services

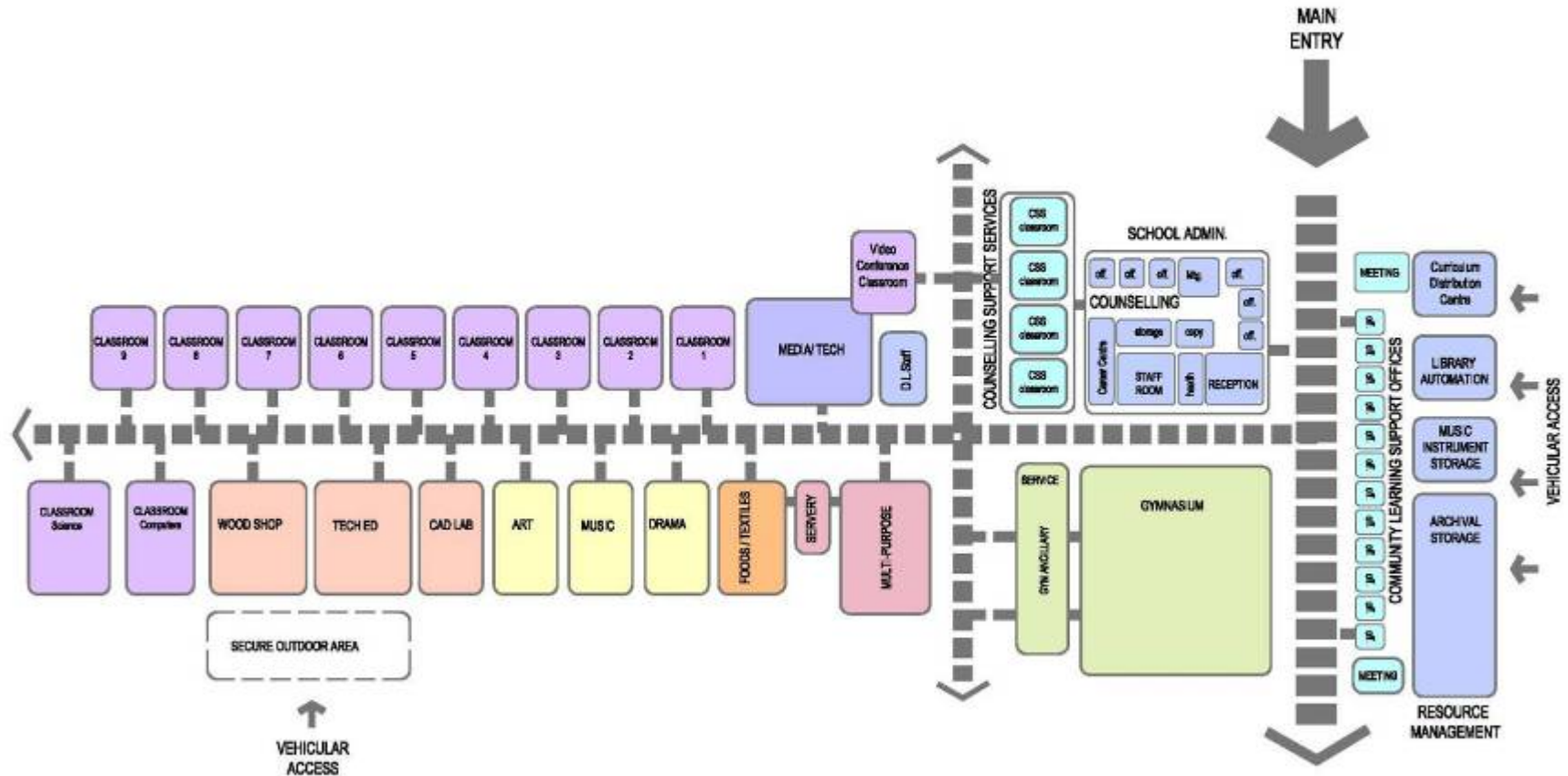

NORTH VANCOUVER SCHOOL DISTRICT LEARNING CENTRE
 SCHOOL DISTRICT NO. 44 NORTH VANCOUVER BC

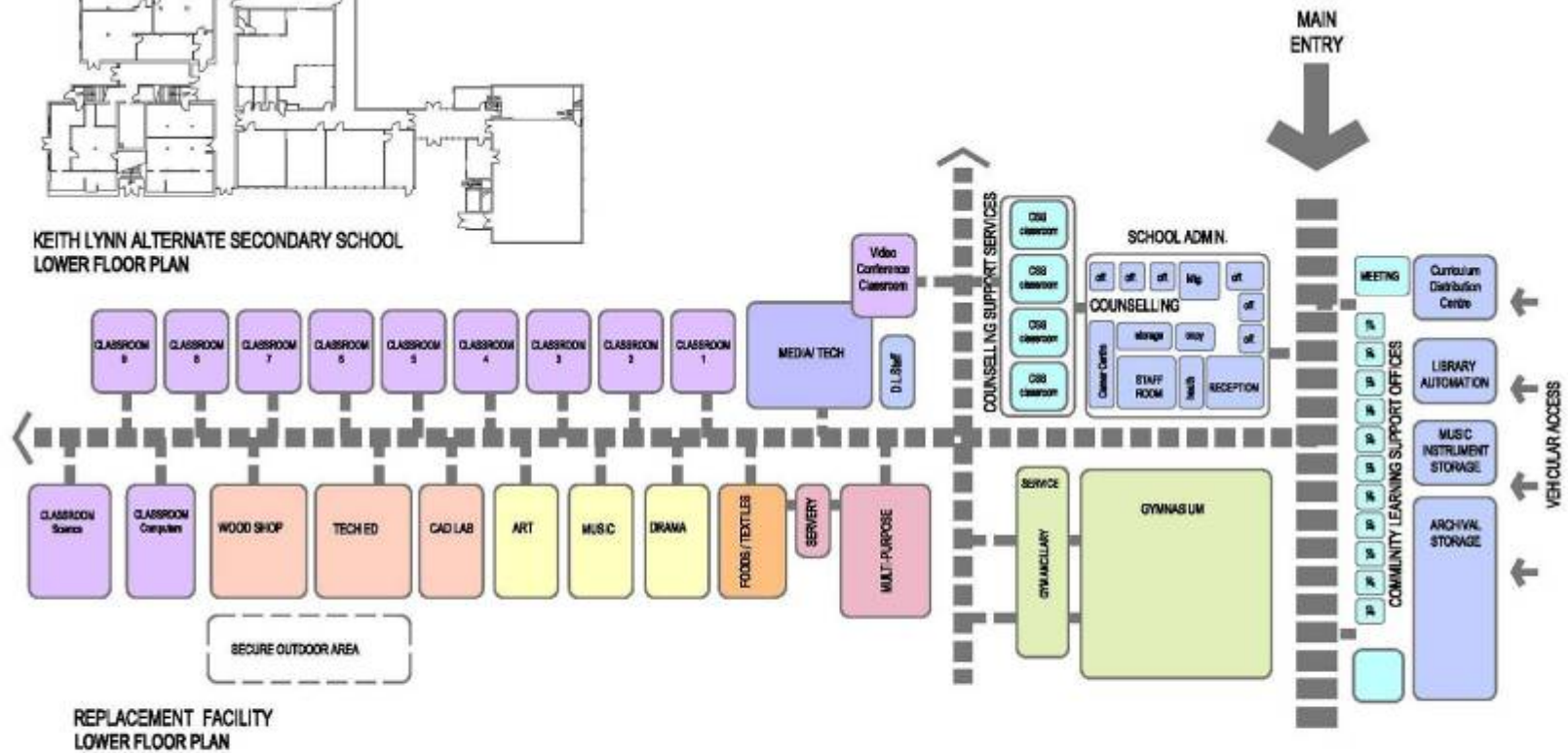
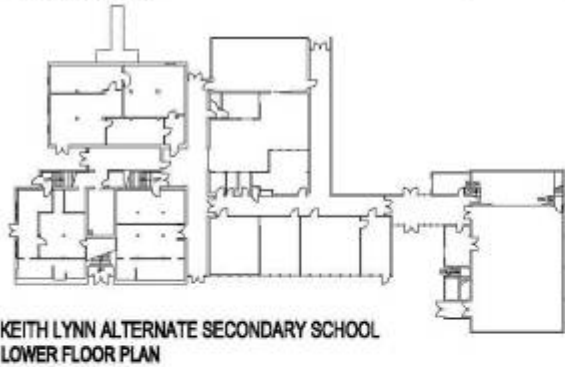
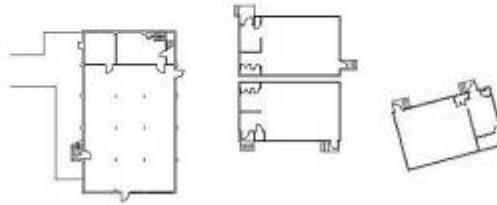
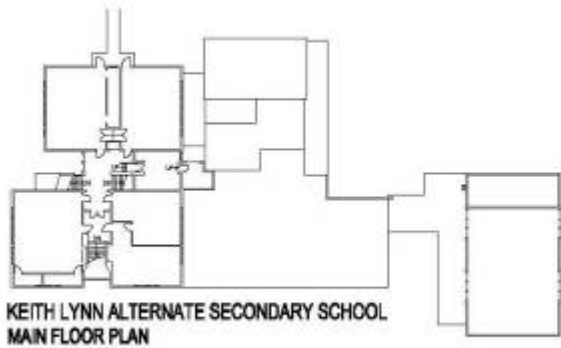

LEGEND

| service/ activity areas |
|---|
| Administration/ Health |
| Counseling/ Career Centre |
| Gym Activity |
| Gym Auxiliary |
| Media Tech Centre (Library) + Video Conference + DL staff |
| Mult Purpose |
| Business Education |
| Music Instruction |
| Visual Art |
| Theater/ Drama |
| Food Instruction/ Textiles |
| Wood Shop |
| Tech Ed. Shop |
| Cad Lab |
| Science Classroom |
| General Classrooms |
| Counseling Support Services |
| Therapist Office |
| Curriculum Distribution Centre |
| Library Automation |
| Music Instrument Storage |
| Archival Storage |

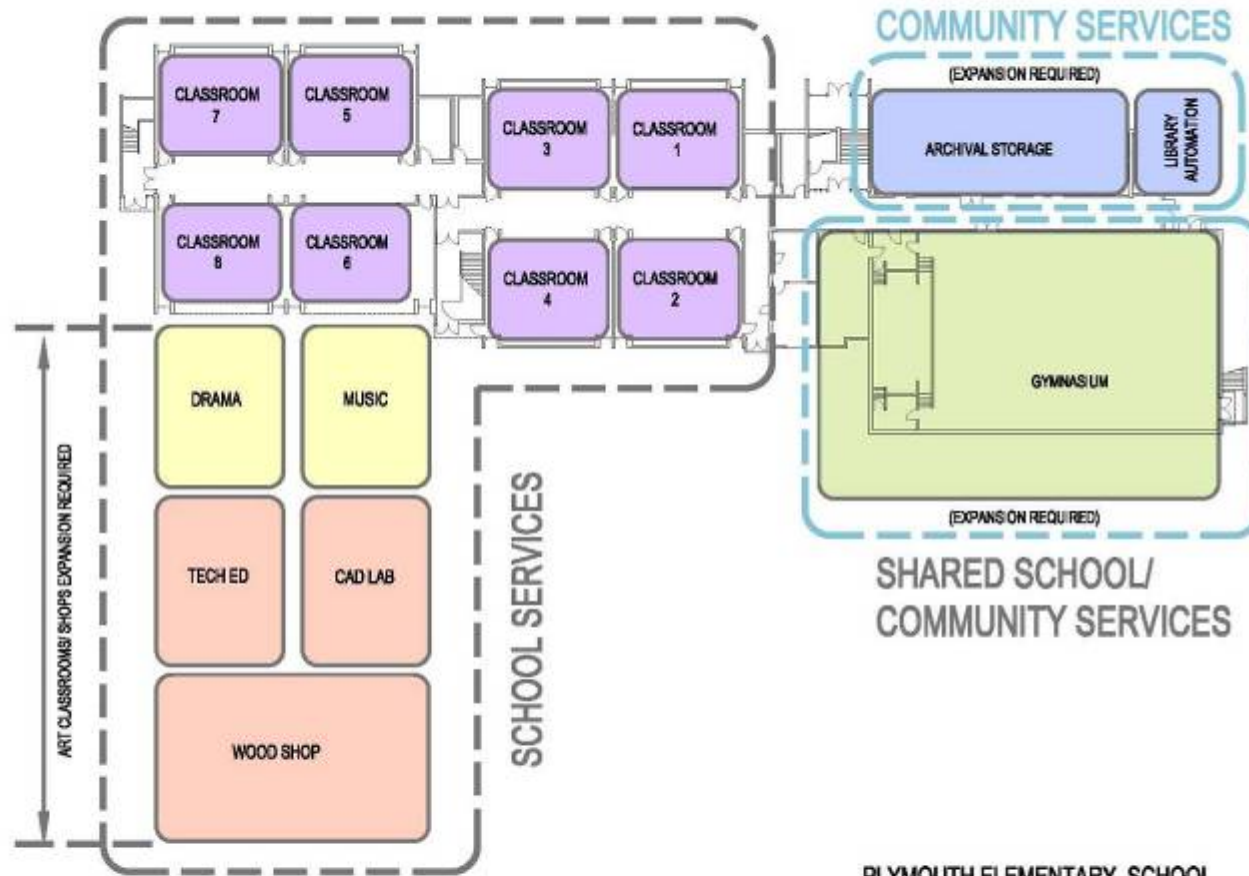

PLYMOUTH ELEMENTARY SCHOOL
LOWER FLOOR PLAN



LEGEND

| service/ activity areas |
|---|
| Administration/ Health |
| Counseling/ Career Centre |
| Gym Activity |
| Gym Ancillary |
| Media Tech Centre (Library) + Video Conference + DL staff |
| Mult Purpose |
| Business Education |
| Music Instruction |
| Visual Art |
| Theatre/ Drama |
| Food Instruction/ Textiles |
| Wood Shop |
| Tech Ed. Shop |
| Car Lab |
| Science Classroom |
| General Classrooms |
| Counseling Support Services |
| Transient Offices |
| Curriculum Distribution Centre |
| Library Automation |
| Music Instrument Storage |
| Archival Storage |

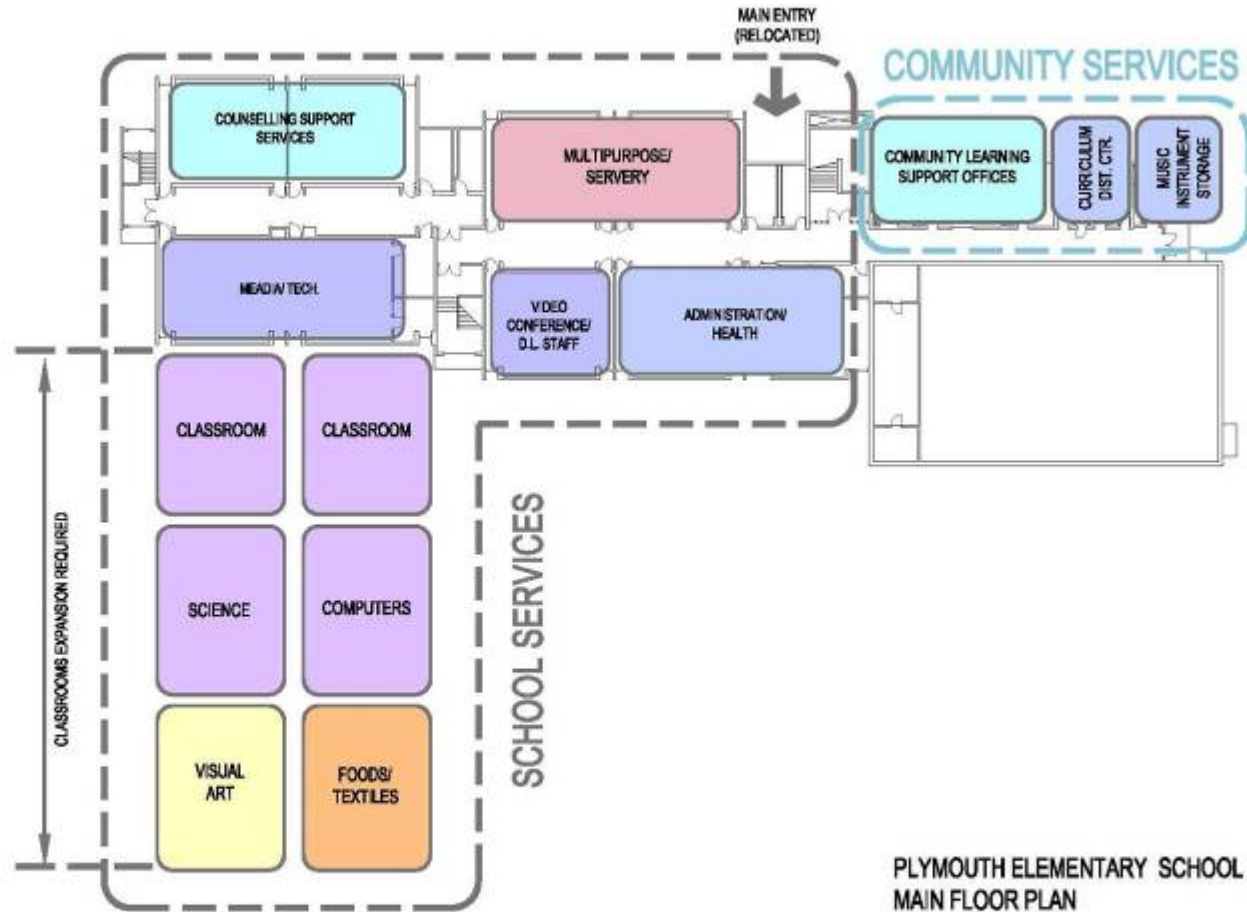

PLYMOUTH ELEMENTARY SCHOOL
MAIN FLOOR PLAN



LEGEND

| service/ activity areas |
|---|
| Administration/ Health |
| Counseling/ Career Centre |
| Gym Activity |
| Gym Ancillary |
| Media Tech Centre (Library) + Video Conference + DL staff |
| Mult Purpose |
| Business Education |
| Music Instruction |
| Visual Art |
| Theatre/Drama |
| Food Instruction/ Trades |
| Wood Shop |
| Tech Ed. Shop |
| Cell Lab |
| Science Classroom |
| General Classrooms |
| Counseling Support Services |
| Internat. Offices |
| Curriculum Distribution Centre |
| Library Automation |
| Music Instrument Storage |
| Archival Storage |

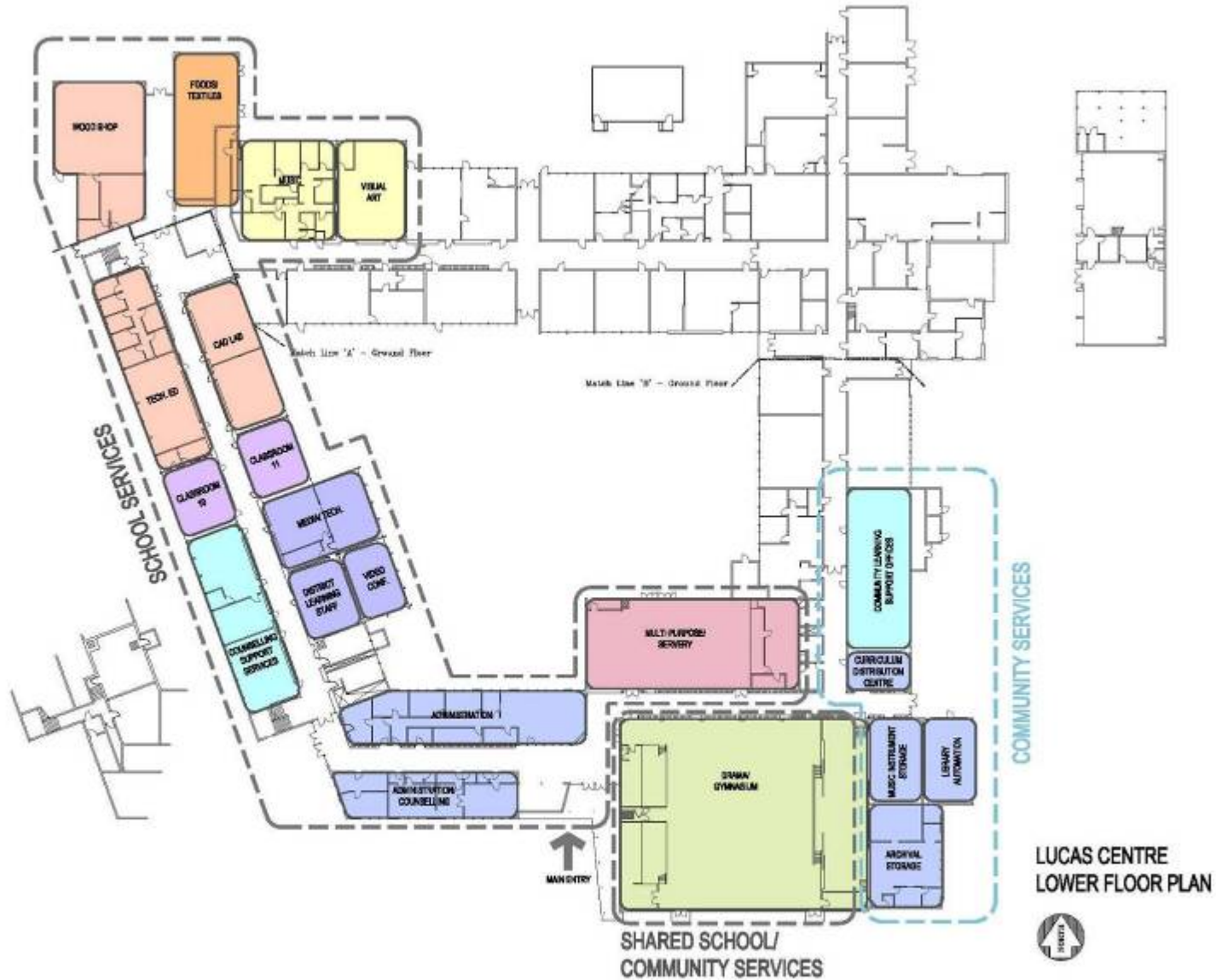

LEGEND

| service/ activity areas |
|---|
| Administration/Health |
| Counseling/ Career Centre |
| Gym Activity |
| Gym Auxiliary |
| Media Tech Centre (Library) + Video Conference + DL staff |
| Multi Purpose |
| Business Education |
| Music Instruction |
| Visual Art |
| Theatre/ Drama |
| Food instruction/ Tardies |
| Wood Shop |
| Tech Ed. Shop |
| Cad Lab |
| Science Classroom |
| General Classrooms |
| Counseling Support Services |
| Element Offices |
| Curriculum Distribution Centre |
| Library Automation |
| Music Instrument Storage |
| Archive Storage |



LUCAS CENTRE
UPPER FLOOR PLAN



LEGEND

| service/ activity areas |
|---|
| Administration/ Health |
| Counseling/ Career Centre |
| Gym Activity |
| Gym Ancillary |
| Media Tech Centre (Library) + Video Conference + DL staff |
| Multi Purpose |
| Business Education |
| Music Instruction |
| Visual Art |
| Theatre/ Drama |
| Food Instruction/ Test/Kit |
| Wood Shop |
| Tech Ed. Shop |
| Cad Lab |
| Science Classroom |
| General Classrooms |
| Counseling Support Services |
| Principal Office |
| Curriculum Distribution Centre |
| Library Automation |
| Music instrument Storage |
| Archive Storage |

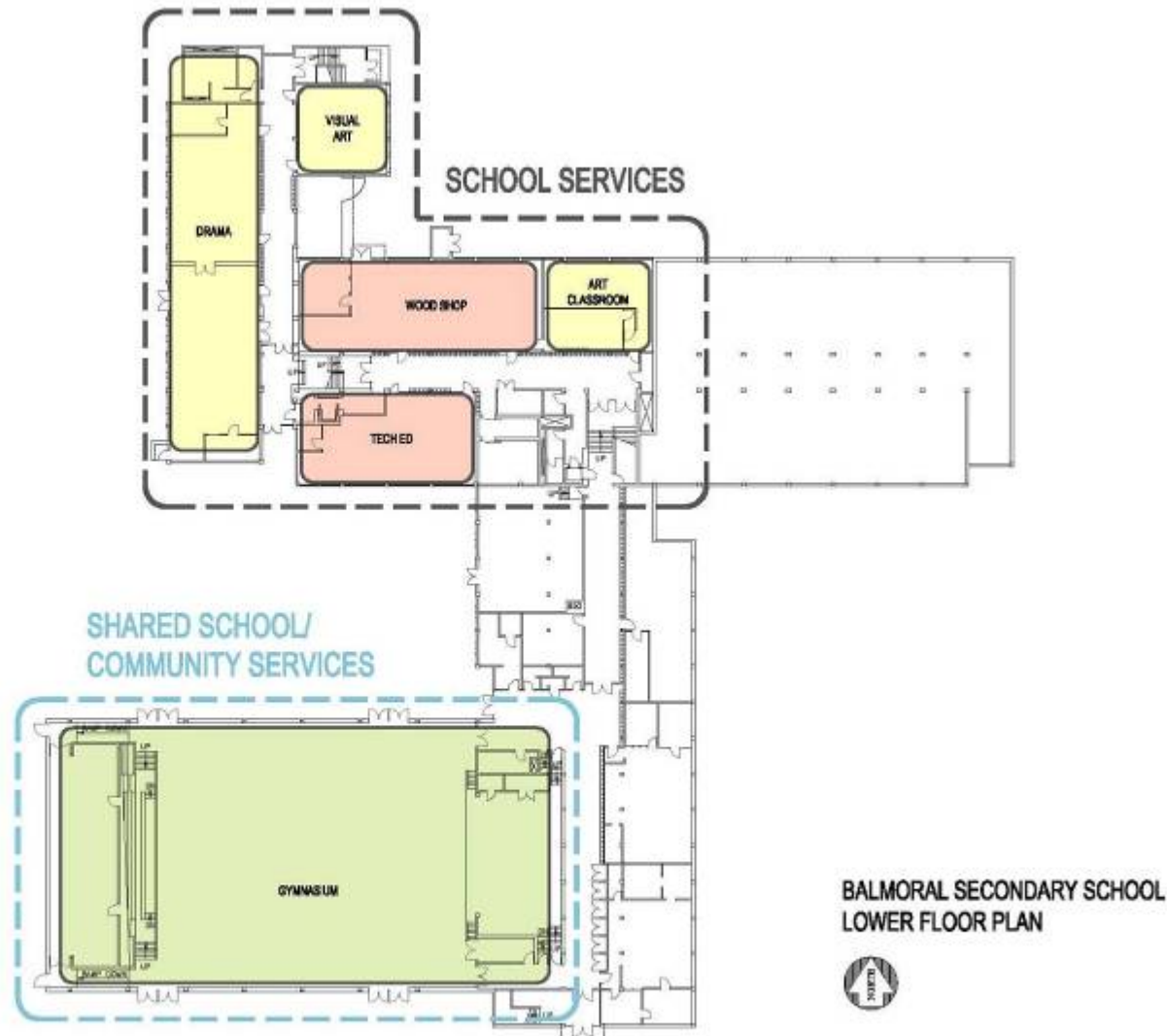

BALMORAL SECONDARY SCHOOL
LOWER FLOOR PLAN



LEGEND

| service/ activity areas |
|---|
| Administration/ Health |
| Counseling/ Career Centre |
| Gym Activity |
| Gym Ancillary |
| Media Tech Centre (Library) + Video Conference + DL staff |
| Multi Purpose |
| Business Education |
| Music Instruction |
| Visual Art |
| Theater/ Drama |
| Food/Instructor/ Textiles |
| Wood Shop |
| Tech Ed. Shop |
| Cad Lab |
| Science Classroom |
| General Classrooms |
| Counseling Support Services |
| Shower Office |
| Curriculum Distribution Centre |
| Library Automation |
| Music Instrument Storage |
| Archival Storage |

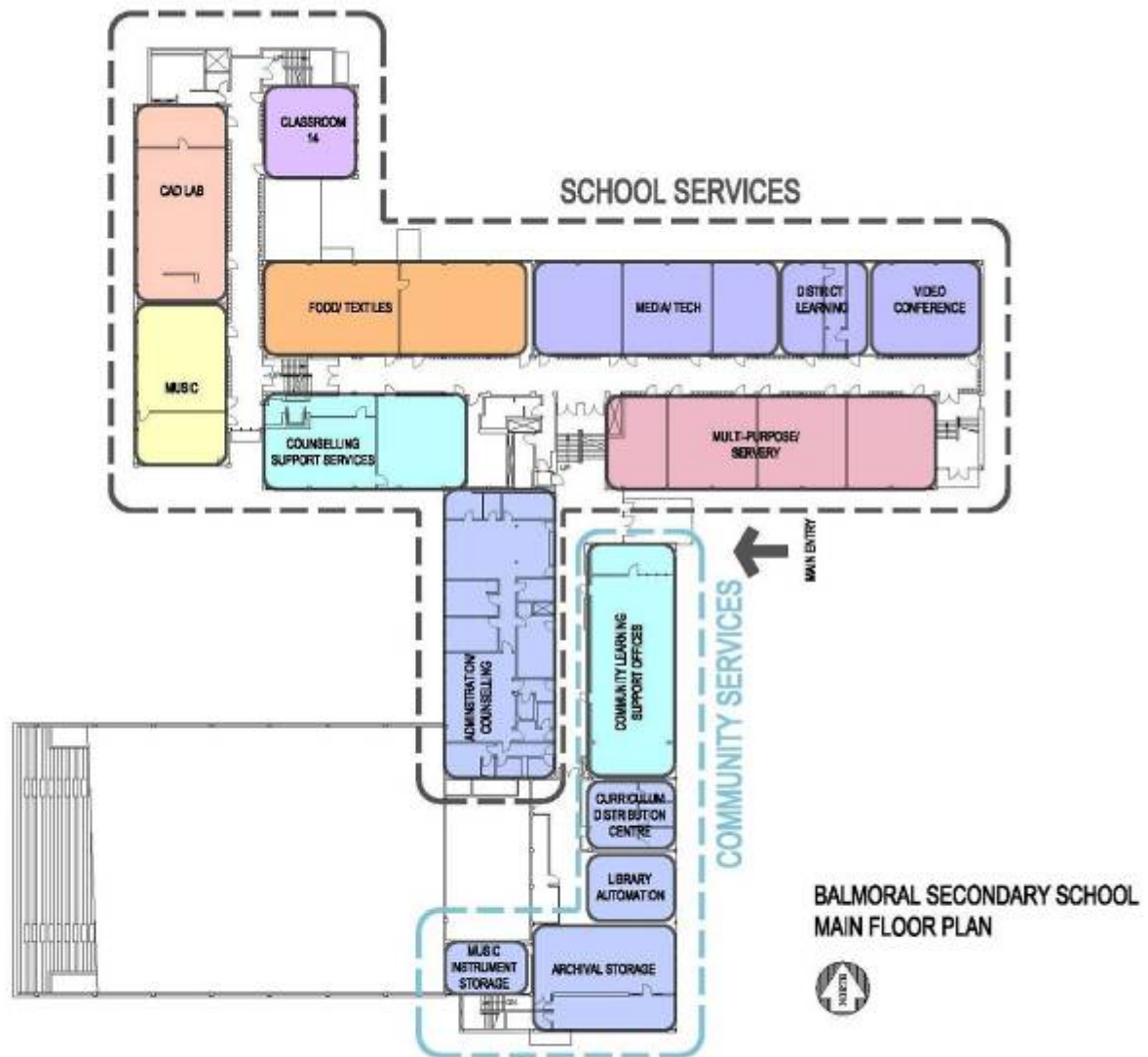

BALMORAL SECONDARY SCHOOL
MAIN FLOOR PLAN

LEGEND

| service/ activity areas |
|---|
| Administration/Health |
| Counseling/ Career Centre |
| Gym Activity |
| Gym Auxiliary |
| Media Tech Centre (Library) + Video Conference + DL staff |
| Mult Purpose |
| Business Education |
| Music Instruction |
| Visual Art |
| Theatre/ Drama |
| Food Instruction/ Testkies |
| Wood Shop |
| Tech Ed. Shop |
| Car Lab |
| Science Classroom |
| General Classroom |
| Counseling Support Services |
| Investment Office |
| Curriculum Distribution Centre |
| Library Automation |
| Music Instrument Storage |
| Archives Storage |

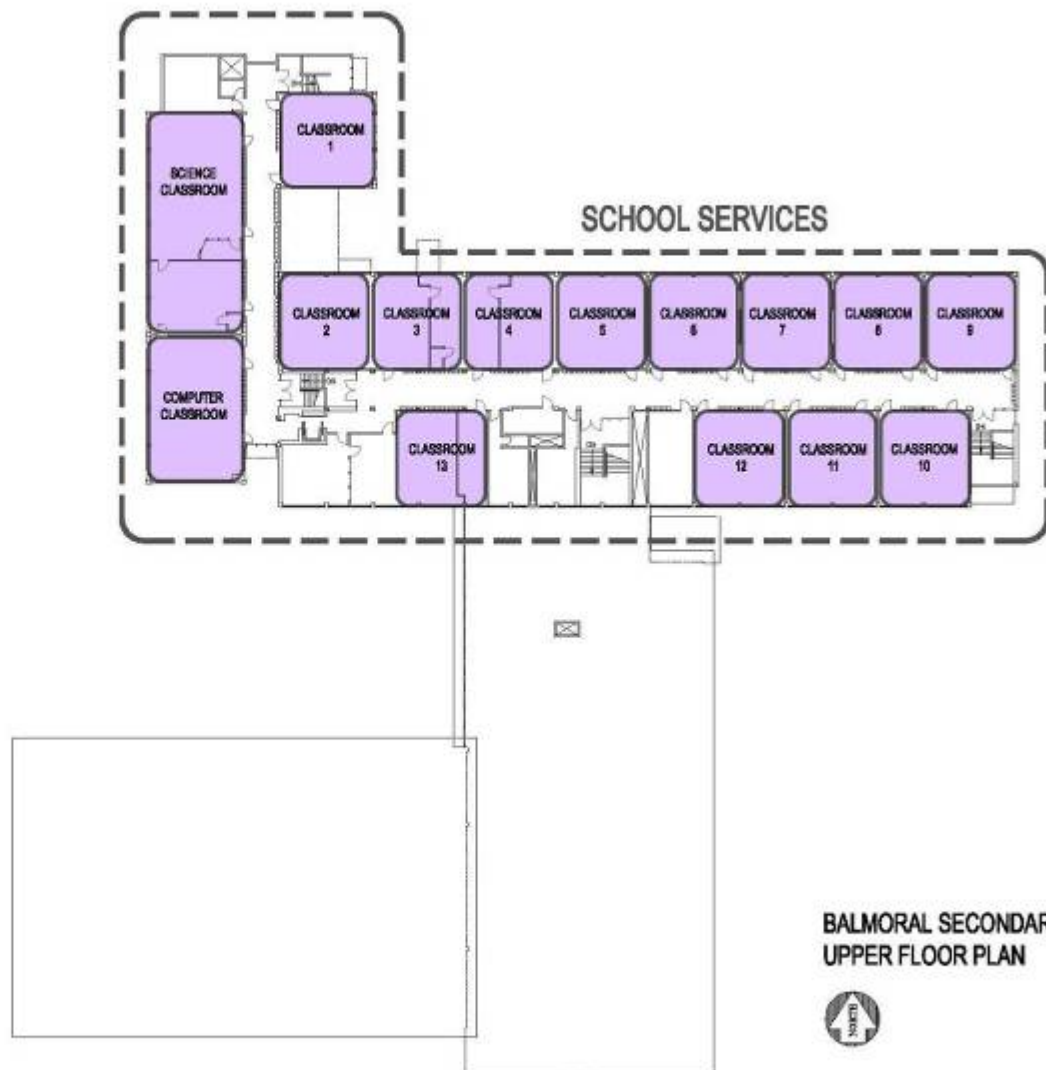

**BALMORAL SECONDARY SCHOOL
UPPER FLOOR PLAN**



COMMUNITY LEARNING PROGRAM - FACILITY OPTION REVIEW

November 5 2011

| Option | A | B | C | D | E | |
|-------------------------------------|---------------------|--|---|--------------------------------|---|-----------------------|
| Issue | New Facility | Keith Lynn Alternate Secondary School | Plymouth Elementary School Renovation + Addition | Lucas Centre Renovation | Balmoral Secondary School Renovation | Recommendation |
| (1) Construction | \$ 15,000,000.00 | \$ 15,000,000.00 | \$ 6,000,000.00 | \$ 5,000,000.00 | \$ 2,500,000.00 | E |
| (2) Lost Opportunity for Land Value | To Be Determined | Minimum lost Value | Medium Lost Value | Maximum lost value | Medium lost Value | B |
| (3) Location | Central | Off-Central | Distant | Off-Central | Central | A & E |
| (4) Facility Suitability | Best | Poor | Poor | Poor | Fair | A |
| (5) Long Term Planning | Good | Poor | Poor | Fair | Good | A & E |
| (6) Educational Programs | Good | Poor | Poor | Fair | Good | A & E |
| (7) Seismic Rating | Best | Fair | Fair | Fair | Fair | A |
| (8) Community Use | Best | Poor | Poor | Fair | Good | A & E |
| | | | | | | E |

Explanatory Notes

(1) Construction values based on the following

New Construction at \$3,000.00 m2
 Renovation rate at \$200.00 m2 simple renovation.
 Renovation rate at \$800.00 m2 for reconfiguration of use
 Renovation rate at \$1800.00 m2 for total reconfiguration / new use
 Balmoral - blended rate at \$500.00 m2
 Lucas Centre - Blended rate at \$1,000.00 m2
 Plymouth - Blended rate of \$1,200.00 m2 (new / reno)
 Keith Lynn Alternate - New Facility recommended.
 Area of Facility - approximately 5000 m2

(2) Lost Opportunity for Land Value

use of site for school results in potential loss of land value

(3) Location

Central location within North Vancouver is most desirable

(4) Facility Suitability

Suitability of Existing facility for secondary school - Size, durability, construction type

(5) Long Term Planning

Compatibility with long term planning in School District

(6) Educational Programs

Suitability of existing facility to suit variety of program spaces required

(7) Seismic Rating

Structural stability of building to withstand a seismic event & cost to upgrade.

(8) Community Use

Suitability of Existing facility for Community uses.

Timelines - Phases

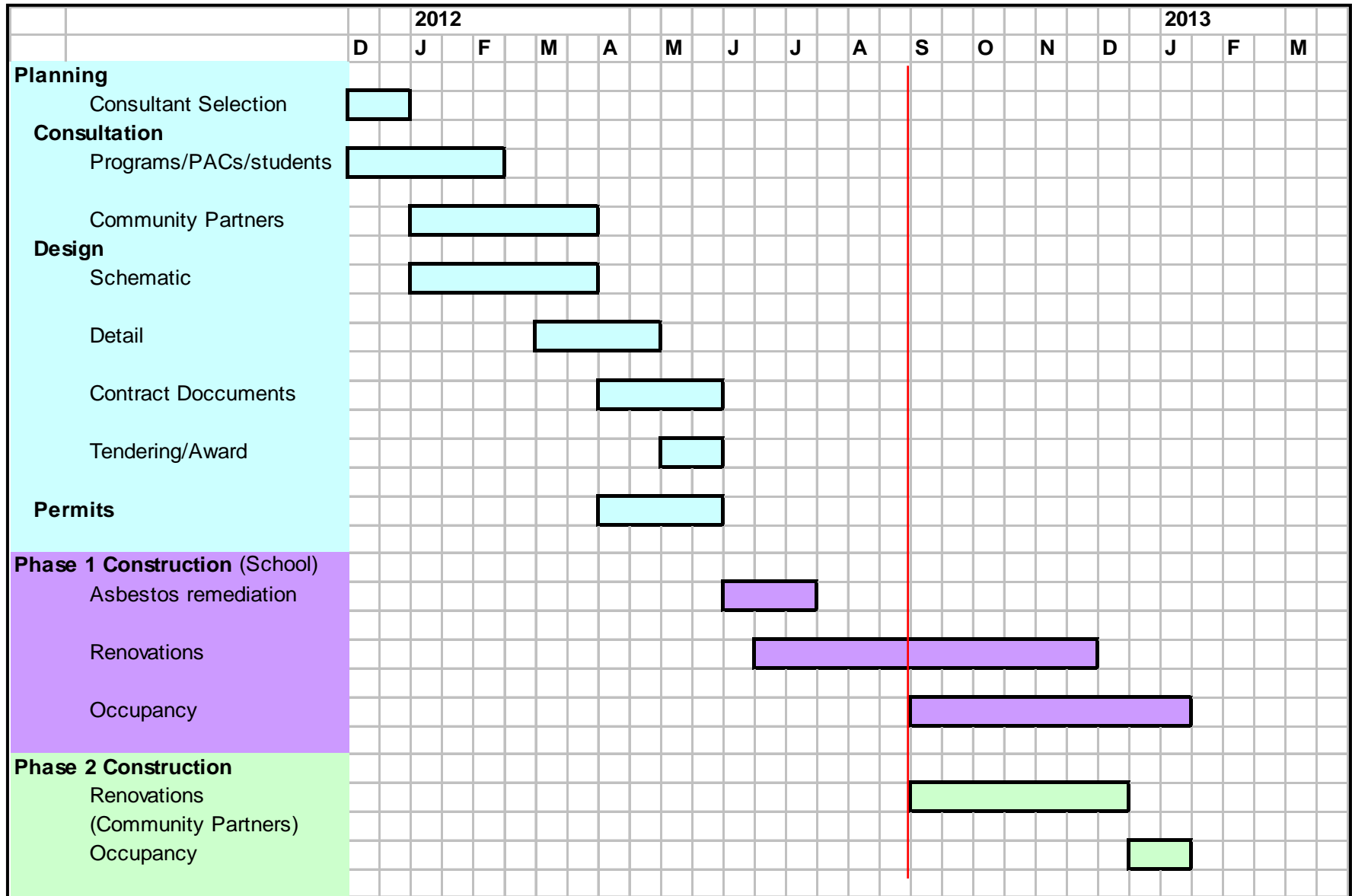

| | |
|---|--|
| SCHOOL NAME | Community Learning Program (NVSD Learning Centre) |
| CRITERIA AREA | Demographics |
| <p>A total of 248 students currently attend Keith Lynn, TDP, and YLC from across North Vancouver. The Choices program pilot at Sutherland provides in-school support for 10 to 12 students at a time, enabling services to 40 to 50 students during the year. Expanding the Choices program to all secondary schools will achieve in-school supports and services for up to 240 to 300 students. With increased supports provided at each school, the total population of students served by the alternate program is expected to decline by 15 to 20 students per year for the next few years. Within two to three years, the program will enrol approximately 200 students from Grades 9 to 12. More than 67% of the current student population are students with special needs, with 17% being students of aboriginal ancestry. Approximately 5% (12) of the students enrolled in our alternate programs are from out of the district.</p> | |
| CRITERIA AREA | Utilization/Space Available |
| <p>The Lucas Centre currently accounts for a total of 204 FTE Enrolment. This includes students enrolled in TDP, YLC, Continuing Education (CE), and the Distributed Learning (DL) program. Many CE and DL students attend Lucas on a part-time basis, or not at all. Approximately 35% of the students enrolled in CE and DL are from outside the school district. The Keith Lynn facility presently accommodates 103 FTE students. Current capacity utilization at secondary schools is 95%, with a total enrolment of approximately 6750, including International students. Student enrolment at the secondary level will decline by approximately 150 to 200 students each year, for the next three years, resulting in reduction in the use of portable classrooms, a slight increase in available space, and improved flexibility to support the in-school Choices program and elective offerings.</p> | |



| CRITERIA AREA | Financial |
|--|----------------|
| <p>The actual overhead costs on a per full time equivalent (FTE) pupil basis are \$3,728 at Keith Lynn and approximately \$3,500 at the Lucas Centre. The average overhead costs per full time equivalent student is approximately \$1,350 at our secondary schools. The consolidation of the alternate program into a single site will achieve estimated annual savings of \$400,000, with overhead costs estimated at \$2,600 per FTE. These savings would be reinvested in the expansion of the Choices Program at all secondary schools, estimated at a total cost of \$600,000. Additional savings will be achieved through efficiencies related to other district services presently located at the LMCC and at the Lucas Centre. The potential for revenue generation for Lucas, Keith Lynn, and Plymouth is primarily related to the surplus land disposition plan. Short-term rental revenues have limited potential and would restrict longer-term revenue potential through land disposition strategies. Opportunity costs for each of the potential sites has been taken into consideration in association with the long-term land retention and disposition strategy.</p> | |
| CRITERIA AREA | Physical Plant |
| <p>The current facilities accommodating the alternate programs are in poor condition with poor functionality. Minor upgrades have been provided over the years, but generally the facilities are 'dated' and below standard. The Keith Lynn facility is significantly below standard, with the majority of the facility beyond its intended life. While standard classrooms are in reasonable condition in the Lucas Centre for the delivery of standard courses, the specialty instructional areas are lacking, or non-existent. When Hamilton Junior Secondary was converted to the Lucas Centre in the early 1980s, the science labs, industrial education facilities and other specialty areas were removed, or converted into standard classrooms. Built as an elementary school, Plymouth lacks the specialty instructional areas necessary to provide a comprehensive program for secondary-aged students.</p> | |



| | |
|--|--------------------------------------|
| CRITERIA AREA | Location |
| <p>The Lucas Centre is located on the western portion of the school district in the Hamilton Heights area. Access is fair to poor and public transit is poor. Keith Lynn is situated in the Lower Lynn area with fair to poor access through a residential community. Keith Lynn is situated in proximity to the highway interchange and a major portion of the site has been identified by the Ministry of Transportation and Highways for future improvements. Plymouth elementary is situated in the Windsor area with fair access in a residential community. This area of the school district now serves only 25% of the total student population. Balmoral is more centrally located than other sites and is in the area of the School District serving 75% of the total student population.</p> | |
| CRITERIA AREA | Community / District Services |
| <p>Limited community services are provided on-site at our current alternate program locations. Services are provided by community agencies on a scheduled, or ad hoc basis. Travel time between sites reduces the time available for student contact and services. Community agencies have expressed strong interest in the potential for co-location with the district's Community Learning Program. This would enhance the delivery of support services to students and to staff. Various district services are provided at the Lucas site and in connection to the LMCC and AFK program. A number of these functions will be relocated to the new Education Services Centre and AFK Gallery.</p> | |
| CRITERIA AREA | Programs |
| <p>Both the Lucas Centre and Keith Lynn facility have limited course and program opportunities (i.e. specialized instructional spaces, district programs) for students. A number of renovations (interior walls) have been completed over the years to help support program delivery. The educational program opportunities for students are seriously limited by the instructional spaces lacking in these facilities. Plymouth Elementary does not have the specialty instructional areas necessary to provide secondary program electives. The Balmoral facility currently provides most specialty instructional areas needed.</p> | |



FURTHER CONSIDERATIONS

The consolidation of the Alternate Programs into one location provides the opportunity for a new identity and image. To create a welcoming experience, a positive learning environment, and good functional relationships within the facility, interior renovations are recommended. These renovations should proceed on a phased approach, focusing first on students and staff, secondly on district and community services and finally on joint use (Neighbourhood of Learning) supports.

The Surplus Land Retention and Disposition Strategy identifies the surplus properties of the School District that have potential for redevelopment. The Plymouth site is identified as a medium-term retention and is being considered through an REI process. Balmoral site is identified as a medium-term retention, pending further analysis. The Lucas Centre is identified as a short-term retention with potential for redevelopment within a 3 to 5 year period. The opportunity costs related to the Lucas Centre is very high as a result of its very high revenue generating potential. Plymouth and Balmoral opportunity costs are moderate as a result of their moderate revenue generating potential.

The central location of the Balmoral site in comparison to the adjacent four secondary schools, now serving 75% of our secondary student population, supports long-term retention of this site to provide for any potential future needs beyond 25 years. Although the need for an enrolling secondary school is expected to be low for 50 to 75 years, the central location of this site supports longer-term retention. The Balmoral facility provides opportunities for on-site community services for our students and the ability to achieve efficiencies for a number of district services (other than maintenance). The central location of the Balmoral site also provides potential to address community needs.

Executive Committee Recommendation for Program Location: **Balmoral**



Next Steps

- Inform all parents, staff and partner groups
- Continue to meet with alternate program staff, parents, PACs and students
- Engage consultant team (Architect & Engineers)
- Establish facility design working group
- Continue program development (District & Choices)
- Continue consultation with potential partners and community agencies
- Proceed with implementation planning with reps of alternate programs and local PACs
- Continue working with DNV and PACs regarding traffic management

